

Changing Oil

Drain the oil while the engine is still warm to assure rapid and complete draining. Change oil every 50 Hours with 10W30 oil.

1. Remove the oil filter cap, and drain the oil.
2. Refill with the recommended oil and check the level.

OIL CAPACITY: 0.6 lit.
(0.63 US qt, 0.53 Imp. qt)

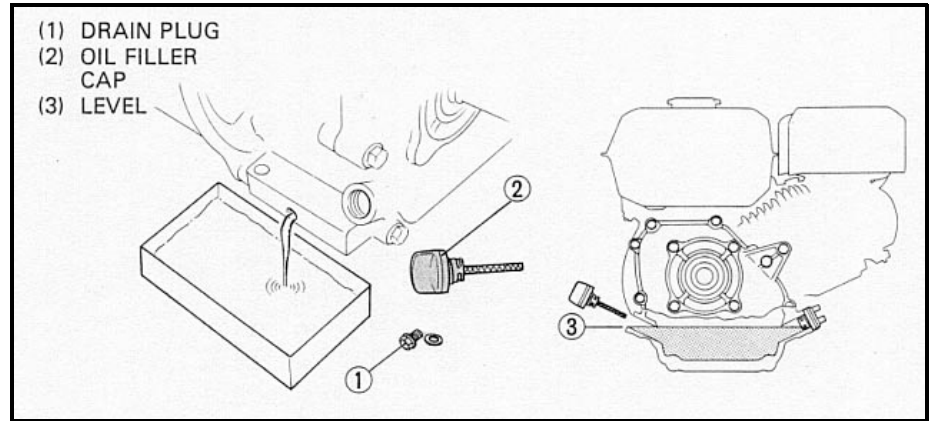

Air Cleaner Service

A dirty air cleaner will restrict the air flow to the carburetor. To prevent carburetor malfunction, service the air cleaner regularly. Service more frequently when operating the engine in extremely dusty areas.



WARNING: Never use gasoline or low flash point solvents for cleaning the air cleaner element. A fire or explosion could result.

CAUTION: Never run the engine without the air cleaner.
Rapid engine wear may result.

Dry Type:

1. Remove the wing nut and the air cleaner cover. Remove the elements and separate them. Carefully check both elements for holes or tears and replace if damaged.
2. Foam element: Clean in warm soapy water, rinse and allow to dry thoroughly. Or clean in high flash-point solvent and allow to dry. Dip the element in clean engine oil and squeeze out all the excess. The engine will smoke during initial start-up if too much oil is left in the foam.
3. Paper element: Tap the element lightly several times on a hard surface to remove excess dirt, or blow compressed air through the filter from the inside out. Never try to brush the dirt off; brushing will force the dirt into the fibres.

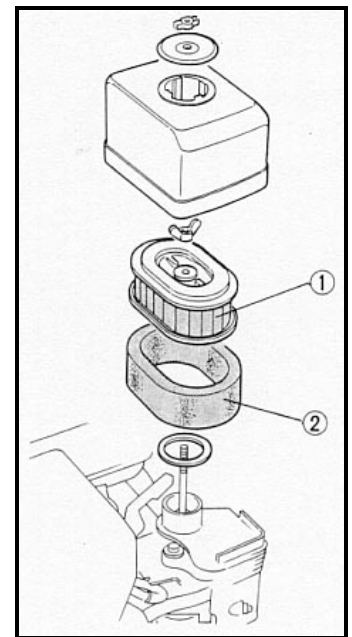

(1) Paper element
(2) Foam element

